

**PROPOSED LAYOUT POPLAR WALK**

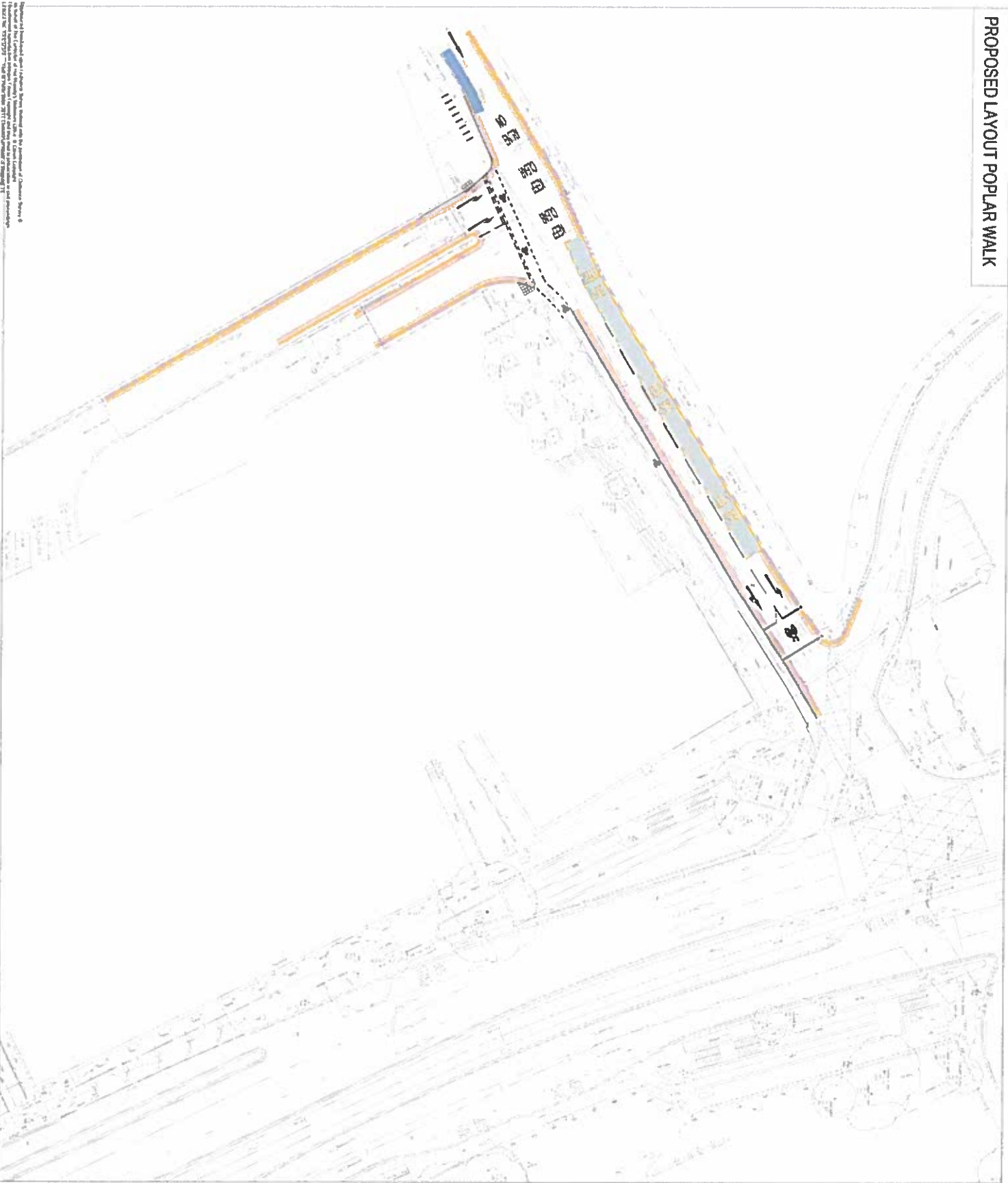

- Key:**
- Double Yellow Line (diagram 1018:1)
  - Taxis Parking Bays
  - Bus Stop

| Drawn | Checked | Date | By |
|-------|---------|------|----|
|       |         |      |    |
|       |         |      |    |
|       |         |      |    |

**FOR INFORMATION**

**WELLESLEY ROAD PHASE 1**

**PROPOSED LAYOUT POPLAR WALK**

**CROYDON**  
www.croydon.gov.uk

**pba peterdrett**  
www.peterdrett.com

24/08/2015

1:200

24856/003/075

Reference to the London Underground Act 1932 and the London Underground Act 1962. The London Underground Act 1932 and the London Underground Act 1962 are hereby incorporated into this document by reference. The London Underground Act 1932 and the London Underground Act 1962 are hereby incorporated into this document by reference. The London Underground Act 1932 and the London Underground Act 1962 are hereby incorporated into this document by reference.