

APPLICATION FOR A PREMISES LICENCE TO BE GRANTED
UNDER THE LICENSING ACT 2003

If you wish to make representations in relation to this application, please do so in writing no later than 14.07.2026 to the following address:

London Borough of Croydon
Place, Licensing Team,
3rd Floor, Zone B
Bernard Weatherill House
8 Mint Walk
Croydon, CR0 1EA

Or by email to: licensing@croydon.gov.uk

It is an offence to knowingly or recklessly make a false statement in connection with an application. The maximum fine on summary conviction for such an offence is unlimited.



New Premises Licence

Premises Details

Business/Premises Name *

Accosoft Technologies Ltd. t/a Subway

Premises Address *

1491 LONDON ROAD NORBURY LONDON SW16 4AE

Telephone number at premises (if any)

[REDACTED]

Non-domestic value of premises. *

£ 25000

Applicant Details

I/We apply for a premises licence under section 17 of the Licensing Act 2003 for the premises described in Part 1 below (the premises) and I/we are making this application to you as the relevant licensing authority in accordance with section 12 of the Licensing Act 2003.

Please state whether you are applying for a premises licence as:

a person other than an individual - as a limited company/
limited liability partnership

Applicant Details

If you are applying as a person described in one of the above please confirm: *

I am carrying on or proposing to carry on a business which involves the use of the premises for licensable activities; or

Other Applicant (Non Individual)

Name *

Accosoft Technologies Ltd.

Registered Address *

1491 LONDON ROAD

Address line 2

[REDACTED]

Address line 3

[REDACTED]

Other Applicant (Non Individual)

Town/City *	LONDON
County	London
Postcode *	SW16 4AE
Registered Number (where applicable)	08933426
Description of applicant (for example partnership, company, unincorporated association, etc) *	Company
Telephone Number *	
Email *	

Operating Schedule

When do you want the premises licence to start? *	14/07/2026
If you wish the licence to be valid only for a limited period, when do you want it to end?	
Please give a general description of the premises. *	The premises operate as a Subway quick-service restaurant at 1491 London Road, Norbury, London, SW16 4AE, serving freshly prepared food and drinks for eat-in, takeaway and delivery. The application is to allow late night refreshment until 1:30am every day. The premises are food-led, with no alcohol sales or regulated entertainment. Staff, CCTV and standard operating procedures are in place to support the licensing objectives.
If 5,000 or more people are expected to attend the premises at any one time, please state the number expected to attend.	

Operating Schedule

What licensable activities do you intend to carry on from the premises? * (Please see sections 1 and 14 of the Licensing Act 2003 and Schedules 1 and 2 to the Licensing Act 2003)

Provision of regulated entertainment, late night refreshment or supply of alcohol (please read guidance note 2) *

 a) Plays b) Films

Operating Schedule

- c) Indoor Sporting Events
- d) Boxing or Wrestling
- e) Live Music
- f) Recorded Music
- g) Performances of Dance
- h) Anything of a similar description falling under Music or Dance
- i) Provision of Late Night Refreshment
- j) Supply of Alcohol

i) Provision of Late Night Refreshment Standard Times

Standard days and timings, where you intend to use the premises for late night refreshment.(please read guidance note 7) *
Please enter times in 24hr format (HH:MM)

Day *

Every Day

23:00

01:30

i) Provision of Late Night Refreshment

Will the provision of late night refreshment take place indoors or outdoors or both? (please read guidance note 3) *

Indoors

Please provide further details.(please read guidance note 4)

Late night refreshment will be provided indoors only from the existing Subway restaurant premises. This will consist of the sale of hot food and hot drinks for customers eating in, takeaway, and delivery orders. No outdoor late night refreshment will be provided.

i) Provision of Late Night Refreshment

State any seasonal variations for the provision of late night refreshment.(please read guidance note 5)

None

Please state any non-standard timings, where you intend to use the premises for late night refreshment at different times from the Standard days and times listed?(please read guidance note 6)

None

Adult Entertainment

Please highlight any adult entertainment or services, activities, other entertainment or matters ancillary to the use of the premises that may give rise to concern in respect of children (please read guidance note 9). *

None. The premises will not provide any adult entertainment, adult services, or activities that may give rise to concern in respect of children.

Opening Hours Standard Times

Standard days and timings, where the premises are open to the public. (please read guidance note 7) * Please enter times in 24hr format (HH:MM)

Day *

Monday to Thursday

08:00

01:30

Opening Hours Standard Times

Standard days and timings, where the premises are open to the public. (please read guidance note 7) * Please enter times in 24hr format (HH:MM)

Day *

Sunday

10:00

01:30

Opening Hours Standard Times

Standard days and timings, where the premises are open to the public. (please read guidance note 7) * Please enter times in 24hr format (HH:MM)

Day *

Friday

Opening Hours Standard Times

08:00

01:30

Opening Hours Standard Times

Standard days and timings, where the premises are open to the public. (please read guidance note 7) * Please enter times in 24hr format (HH:MM)

Day *

Saturday

09:00

01:30

Opening Hours

State any seasonal variations. (please read guidance note 5)

None

Please state any Non-standard timings, where you intend the premises to be open to the public at different times from the Standard days and times listed? (please read guidance note 6)

Monday to Sunday: 23:00 to 01:30

Licensing Objectives

Describe the steps you intend to take to promote the four licensing objectives:

a) General - all four licensing objectives (b, c, d and e) (please read guidance note 10)

The premises will operate as a food-led Subway quick-service restaurant. Late night refreshment will be provided indoors only. The premises will have staff on duty during trading hours, CCTV in operation, appropriate staff training, and management controls in place to promote all four licensing objectives. The premises will not sell alcohol or provide regulated entertainment.

b) The prevention of crime and disorder *

CCTV will be in operation at the premises and recordings will be retained and made available to responsible authorities upon request. Staff will be trained to monitor customer behaviour and manage any issues appropriately. The premises will not sell alcohol. Any incidents will be recorded and, where necessary, reported to the police. Staff will refuse service to anyone behaving in an aggressive, disorderly or inappropriate manner.

Licensing Objectives

c) Public safety *

The premises will be maintained in a safe condition for customers, staff and delivery drivers. Suitable fire safety procedures, emergency exits, lighting and health and safety controls will be maintained. Staff will be trained in safe operating procedures, including food safety, customer safety and emergency procedures. The premises will be adequately supervised during trading hours.

d) The prevention of public nuisance *

Staff will monitor customers entering and leaving the premises, particularly during late hours, and will encourage customers and delivery drivers to leave quietly and respectfully. Waste will be managed properly and the surrounding area will be kept clean. Deliveries and collections will be managed to minimise noise and disturbance. No amplified music or regulated entertainment will be provided.

e) The protection of children from harm *

The premises will operate as a food-led quick-service restaurant and will not provide alcohol, adult entertainment or gambling. Staff will be trained to maintain a safe and appropriate environment for all customers, including children and young people. Any safeguarding concerns will be handled appropriately and reported to the relevant authorities where necessary.

Declarations

Declaration Type *

Sole Applicant - Individual or Other

Declarations

I have uploaded a copy of the plan of the premises. I have uploaded a copy of the consent form completed by the individual I wish to be designated premises supervisor, if applicable. I understand I must now advertise my application. I understand that if I do not comply with the above requirements my application will be rejected. Applicable to all individual applicants, including those in partnership which is not a limited liability partnership, but not companies or limited liability partnerships I have included documents demonstrating my entitlement to work in the United Kingdom (please read note 15)

IT IS AN OFFENCE, UNDER SECTION 158 OF THE LICENSING ACT 2003, TO MAKE A FALSE STATEMENT IN OR IN CONNECTION WITH THIS APPLICATION. THOSE WHO MAKE A FALSE STATEMENT MAY BE LIABLE ON SUMMARY CONVICTION TO A FINE OF ANY AMOUNT' 'IT IS AN OFFENCE UNDER SECTION 24B OF THE IMMIGRATION ACT 1971 FOR A PERSON TO WORK WHEN THEY KNOW, OR HAVE REASONABLE CAUSE TO BELIEVE, THAT THEY ARE DISQUALIFIED FROM DOING SO BY REASON OF THEIR IMMIGRATION STATUS. THOSE WHO EMPLOY AN ADULT WITHOUT LEAVE OR WHO IS SUBJECT TO CONDITIONS AS TO EMPLOYMENT WILL BE LIABLE TO A CIVIL PENALTY UNDER SECTION 15 OF THE IMMIGRATION, ASYLUM AND NATIONALITY ACT 2006 AND PURSUANT TO SECTION 21 OF THE SAME ACT, WILL BE COMMITTING AN OFFENCE WHERE THEY DO SO IN THE KNOWLEDGE, OR WITH REASONABLE CAUSE TO BELIEVE, THAT THE EMPLOYEE IS DISQUALIFIED.

Signature/Declaration of applicant or applicant's solicitor or other duly authorised agent (see Guidance Note 11 & 12). If signing/applying on behalf of the applicant, please state your name and in what capacity you are authorised to sign/apply. When submitting an on-line application form the 'Declaration made' checkbox must be selected.

Declarations



I understand I am not entitled to be issued with a licence if I do not have the entitlement to live and work in the UK (or if I am subject to a condition preventing me from doing work relating to the carrying on of a licensable activity) and that my licence will become invalid if I cease to be entitled to live and work in the UK (please read guidance note 15).

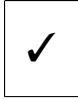

The DPS named in this application form is entitled to work in the UK (and is not subject to conditions preventing him or her from doing work relating to a licensable activity) and I have seen a copy of his or her proof of entitlement to work, if appropriate (please see note 15).

Full Name *

Date *

Capacity *

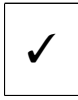

Declaration made

Do you wish to provide alternative correspondence details? *

Email confirmation

On submission an email confirmation will be sent using the details below

Forename

Surname /Company Name

Email *

Telephone

- NOTES
1. Do not scale dimensions from this drawing.
 2. All contractors and sub-contractors must verify sizes and conditions on site before work commences.
 3. Copyright- This drawing is copyright to SHW and may not be reproduced in any form whatsoever without prior express written consent.
 4. References to left or right when identifying elevations, are made assuming facing the front elevation



- SHOPFIT ITEMS KEY
- 1 SIT DOWN COUNTER
 - 2 COMMUNAL TABLE
 - 3 20' x 24' TABLE
 - 4 CHAIR
 - 5 BAR HEIGHT STOOL
 - 6 BOLT DOWN STOOL
 - 7 TRASH RECEPTACLE
 - 8 SODA FOUNTAIN
 - 9 TEA/COFFEE BREWER
 - 10 BEVERAGE DESTINATION CENTER
 - 11 SUBWAY 'OPEN' WINDOW SIGN
 - 12 WALL ART - VERTICAL
 - 13 WALL ART - SQUARE
 - 14 WALL ART - CITYSCAPE PANELS
 - 15 STAINLESS STEEL SUBWAY SIGN
 - 16 INTERIOR DOOR
 - 17 INTERIOR DOOR - BACK OF HOUSE
 - 18 GUIDANCE SYSTEM
 - 19 FRONT COUNTER
 - 20 COOKIE DISPLAY CASE
 - 21 DISPLAY REFRIGERATOR
 - 22 SAFE
 - 23 SUBSHOP 2000 P.O.S.
 - 24 MICROWAVE
 - 25 BREAD OVEN
 - 26 COMBI BREAD CABINET
 - 27 MENUBOARD
 - 28 COUNTER ENTRANCE
 - 29 BACK COUNTER W/HAND SINK
 - 30 REFRIGERATED BACK COUNTER
 - 31 RAPID COOK OVEN
 - 32 SINK
 - 33 MOP SINK
 - 34 HOT WATER TANK
 - 35 STAINLESS STEEL WORKTABLE
 - 36 WALL SHELF
 - 37 HAND SINK
 - 38 NEMCO EASY-SLICER
 - 39 REFRIGERATOR
 - 40 FREEZER
 - 41 STORAGE UNITS
 - 42 SODA STORAGE
 - 43 STEREO SYSTEM
 - 44 OFFICE / TRAINING STATION
 - 45 DESK CHAIRS
 - 46 STAFF LOCKERS
 - 47 SHELVING

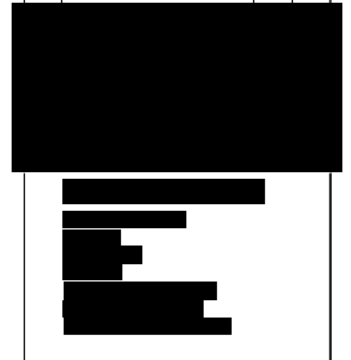
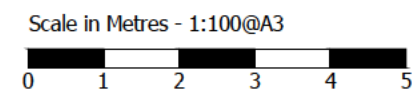
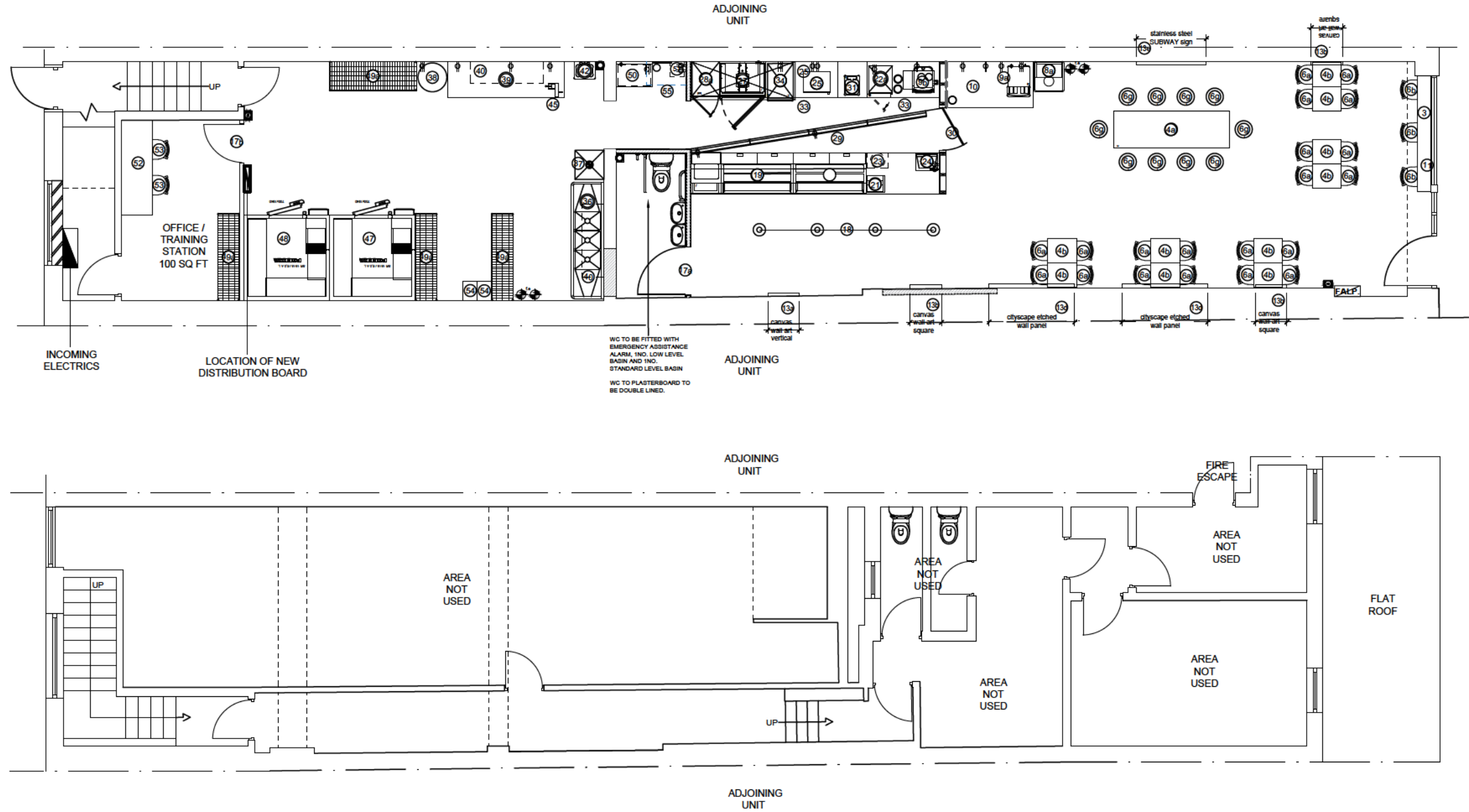

Job
 SUBWAY
 1491 LONDON ROAD
 NORBURY
 LONDON

Scale	Date	Drawn	Checked
1/100@A3	SEPT 15	LH	RM
Number	Revision		