

FLOOR PLANS

WHY DO WE NEED FLOOR PLANS

Floor plans allow us to visually assess the workspace before inspection and upon periodic compliance checks. They also help the fire authorities to assess the premises and make recommendations. This plan can also form part of your Fire Risk Assessment.

INFORMATION

The plan should include:

- Doorways / Openings / Entrance / Exits / Stairs / External, Internal Walls & Columns
- Any steps and number of steps or ramps at a change of floor level
- Description of room e.g. waiting room, treatment room etc
- Toilets, washrooms, bathrooms, showers and sinks
- Lighting, ventilation, heating units
- Fire Alarm devices and location of Fire Hydrants & Blankets

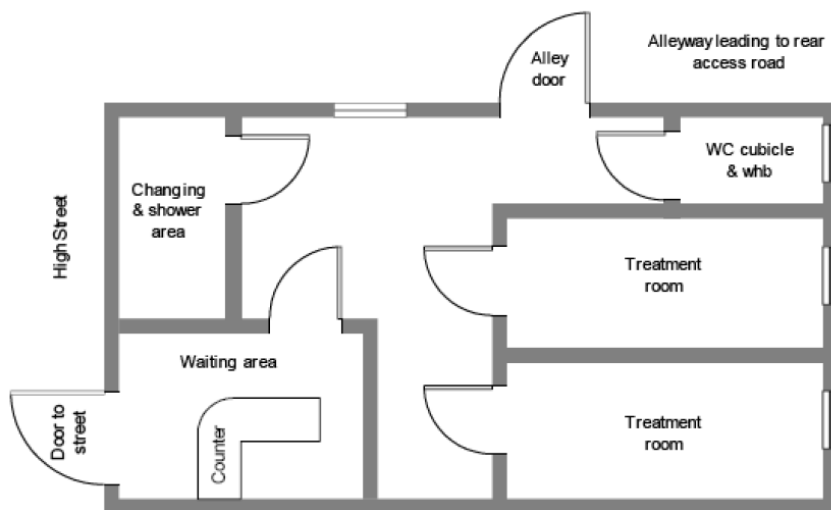

SCALE = 1:100 DATE: 31/12/1999 ADDRESS : 123 HIGH STREET, SOMEWHERE, LONDON

WHEN SHOULD WE SEND PLANS

On Application and every 5 years or sooner if there have been alterations to the premises.